

B5 - B35 Yapı

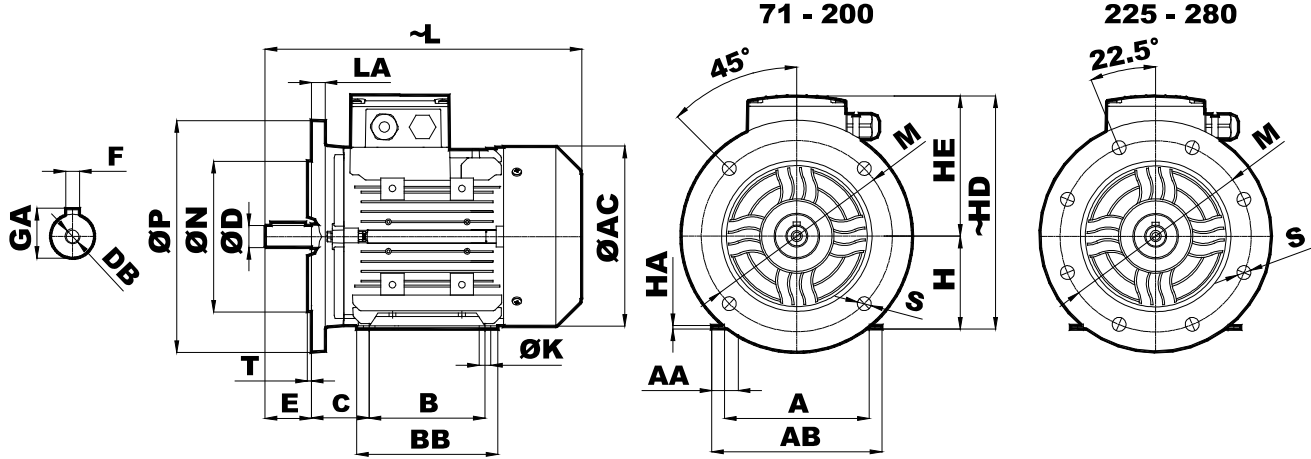

| Gövde Büyüklüğü | Kutup Sayısı | D ^[1] | E | N ^[2] | P | T | LA | L | AC | S | M | H ^[3] | HE | HD | F | GA | DB | C | ØK | B | BB | HA | AA | A | AB |
|-----------------|--------------|------------------|-----|------------------|-----|-----|----|--------|-----|------|-----|------------------|-------|-------|----|------|-----|-----|------|-----|-----|------|------|-----|-----|
| 071 | 2-4-6-8 | 14 | 30 | 110 | 160 | 3,5 | 8 | 244 | 137 | 10 | 130 | 71 | 112 | 183 | 5 | 16 | M5 | 45 | 7 | 90 | 110 | 3 | 19 | 112 | 128 |
| 080 | 2-4-6-8 | 19 | 40 | 130 | 200 | 3,5 | 12 | 274 | 155 | 12 | 165 | 80 | 123 | 203 | 6 | 21,5 | M6 | 50 | 10 | 100 | 122 | 3 | 25 | 125 | 148 |
| 090S | 2-4-6-8 | 24 | 50 | 130 | 200 | 3,5 | 12 | 325 | 176 | 12 | 165 | 90 | 132 | 222 | 8 | 27 | M8 | 56 | 10 | 100 | 151 | 4 | 27 | 140 | 167 |
| 090L | 2-4-6-8 | 24 | 50 | 130 | 200 | 3,5 | 12 | 325 | 176 | 12 | 165 | 90 | 132 | 222 | 8 | 27 | M8 | 56 | 10 | 125 | 151 | 4 | 27 | 140 | 167 |
| 100 | 2-4-6-8 | 28 | 60 | 180 | 250 | 4 | 15 | 370,5 | 193 | 14,5 | 215 | 100 | 149 | 249 | 8 | 31 | M10 | 63 | 12 | 140 | 170 | 4 | 31 | 160 | 192 |
| 112 | 2-4-6-8 | 28 | 60 | 180 | 250 | 4 | 15 | 390 | 215 | 14,5 | 215 | 112 | 161 | 273 | 8 | 31 | M10 | 70 | 12 | 140 | 177 | 4 | 36 | 190 | 217 |
| 132S | 2-4-6-8 | 38 | 80 | 230 | 300 | 4 | 20 | 495 | 257 | 14,5 | 265 | 132 | 181 | 313 | 10 | 41 | M12 | 89 | 12 | 140 | 212 | 5 | 34 | 216 | 254 |
| 132M | 2-4-6-8 | 38 | 80 | 230 | 300 | 4 | 20 | 495 | 257 | 14,5 | 265 | 132 | 181 | 313 | 10 | 41 | M12 | 89 | 12 | 178 | 212 | 5 | 34 | 216 | 254 |
| 160M | 2-4-6-8 | 42 | 110 | 250 | 350 | 5 | 20 | 605 | 316 | 18,5 | 300 | 160 | 224 | 384 | 12 | 45 | M16 | 108 | 14,5 | 210 | 323 | 15 | 49,5 | 254 | 295 |
| 160L | 2-4-6-8 | 42 | 110 | 250 | 350 | 5 | 20 | 605 | 316 | 18,5 | 300 | 160 | 224 | 384 | 12 | 45 | M16 | 108 | 14,5 | 254 | 323 | 15 | 49,5 | 254 | 295 |
| 180M | 2-4-6-8 | 48 | 110 | 250 | 350 | 5 | 14 | 697 | 348 | 18,5 | 300 | 180 | 250 | 430 | 14 | 51,5 | M16 | 121 | 14,5 | 241 | 319 | 15 | 50 | 279 | 326 |
| 180L | 2-4-6-8 | 48 | 110 | 250 | 350 | 5 | 14 | 697 | 348 | 18,5 | 300 | 180 | 250 | 430 | 14 | 51,5 | M16 | 121 | 14,5 | 279 | 319 | 15 | 50 | 279 | 326 |
| 200 | 2-4-6-8 | 55 | 110 | 300 | 400 | 5 | 14 | 740 | 396 | 18,5 | 350 | 200 | 287 | 487 | 16 | 59 | M20 | 133 | 18,5 | 305 | 350 | 18 | 62,5 | 318 | 381 |
| 225S | 4-6-8 | 60 | 140 | 350 | 450 | 5 | 20 | 825 | 438 | 18,5 | 400 | 225 | 315,5 | 540,5 | 18 | 64 | M20 | 149 | 18,5 | 286 | 370 | 20 | 70 | 356 | 428 |
| | 2 | 55 | 110 | | | | | 795 | | | | | | | 16 | 59 | | | | | | | | | |
| 225M | 4-6-8 | 60 | 140 | 350 | 450 | 5 | 20 | 825 | 438 | 18,5 | 400 | 225 | 315,5 | 540,5 | 18 | 64 | M20 | 149 | 18,5 | 311 | 370 | 20 | 70 | 356 | 428 |
| | 2 | 55 | 110 | | | | | 795 | | | | | | | 16 | 59 | | | | | | | | | |
| 250M | 4-6-8 | 65 | 140 | 450 | 550 | 5 | 20 | 896 | 481 | 18,5 | 500 | 250 | 335 | 585 | 18 | 69 | M20 | 168 | 24 | 349 | 420 | 32,5 | 80 | 406 | 490 |
| | 2 | 60 | 140 | | | | | | | | | | | | 64 | 64 | | | | | | | | | |
| 280M | 4-6-8 | 75 | 140 | 450 | 550 | 5 | 20 | 1019,5 | 547 | 18,5 | 500 | 280 | 402 | 682 | 20 | 79,5 | M20 | 190 | 24 | 419 | 500 | 36 | 121 | 457 | 558 |
| | 2 | 65 | 140 | | | | | | | | | | | | 18 | 69 | | | | | | | | | |

[1] Tolerans 28mm'ye kadar "j6" 28mm'den 48'e kadar "k6" 48mm üzeri "m6" TS EN 50347

[2] Tolerans 250 mm'ye kadar "j6" 250 mm üzeri "h6" TS EN50347

[3] Tolerans "-0.5mm" TS EN 50347