

AGM 80 6a

3-Phase 230/400 V 50 Hz

Duty Type : S1

Degree of protection : IP 55 (TEFC)

Insulation class : F (155 °C)

Temp rise : Class B (80K)

Mounting Design : B3

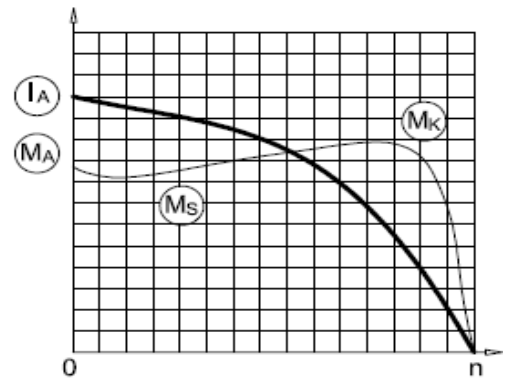

ELECTRICAL DESIGN

Direct On Line

Rated output (kW) : 0.37

Speed (rpm) : 910

Rated current (A) : 1.1

Torque – Mn (Nm) : 3.88

Cos φ : 0.67

Efficiency % : $\frac{4/4}{72.9}$ $\frac{3/4}{72.8}$ $\frac{1/2}{70.1}$

Moment of inertia J (kgm)² : 0.0017

Locked rotor Current – Ia (A) : 4

Ia / In : 3.6

Locked rotor Torque – Ma (Nm) : 8

Ma / Mn : 2.1

Y / Δ Starting

Locked rotor Current – Ia (A) : -

Ia / In : -

Locked rotor Torque – Ma (Nm) : -

Ma / Mn : -

Breakdown Torque – Mk (Nm) : 9

Mk / Mn : 2.4

MECHANICAL DESIGN

Frame : Aluminium

End shields : Aluminium

Cooling fan : Plastic

Terminal box : Plastic

Cable gland : Pg 16

No of cable glands : 1

Bearing Arrangement

Standard design

Reinforced design

Noise Level (dB-A) : 43

Paint : RAL 7031- Grey

Approximate weight (kg) : 8.1

Drive End

6204 ZZ

-

Non Drive End

6204 ZZ

-

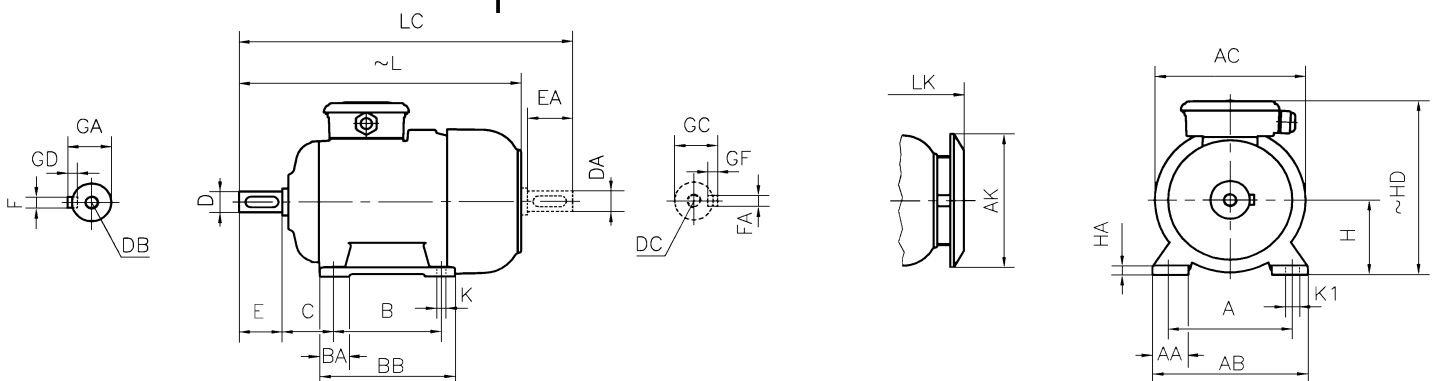

DIMENSIONS

Dimensions of foot mounted motors for mounting arrangement : B3, B6, B7, B8, B15, V5, V6

H	HD ~	HA	A	AA	AB	ØAC	ØAK	K	K1	B	B'	BA	BA'	BB	L ~	LC	LK ~	C	E EA	DB DC	ØD ØDA	GA GC	FxGD FAXGF
80	198	10	125	38	160	156	151	10	15	100	-	33	-	125	279	324	308	50	40	M6	19	21.5	6X6

* Efficiencies are calculated according to indirect method where the additional load losses are determined from exact measurements at different load points.